

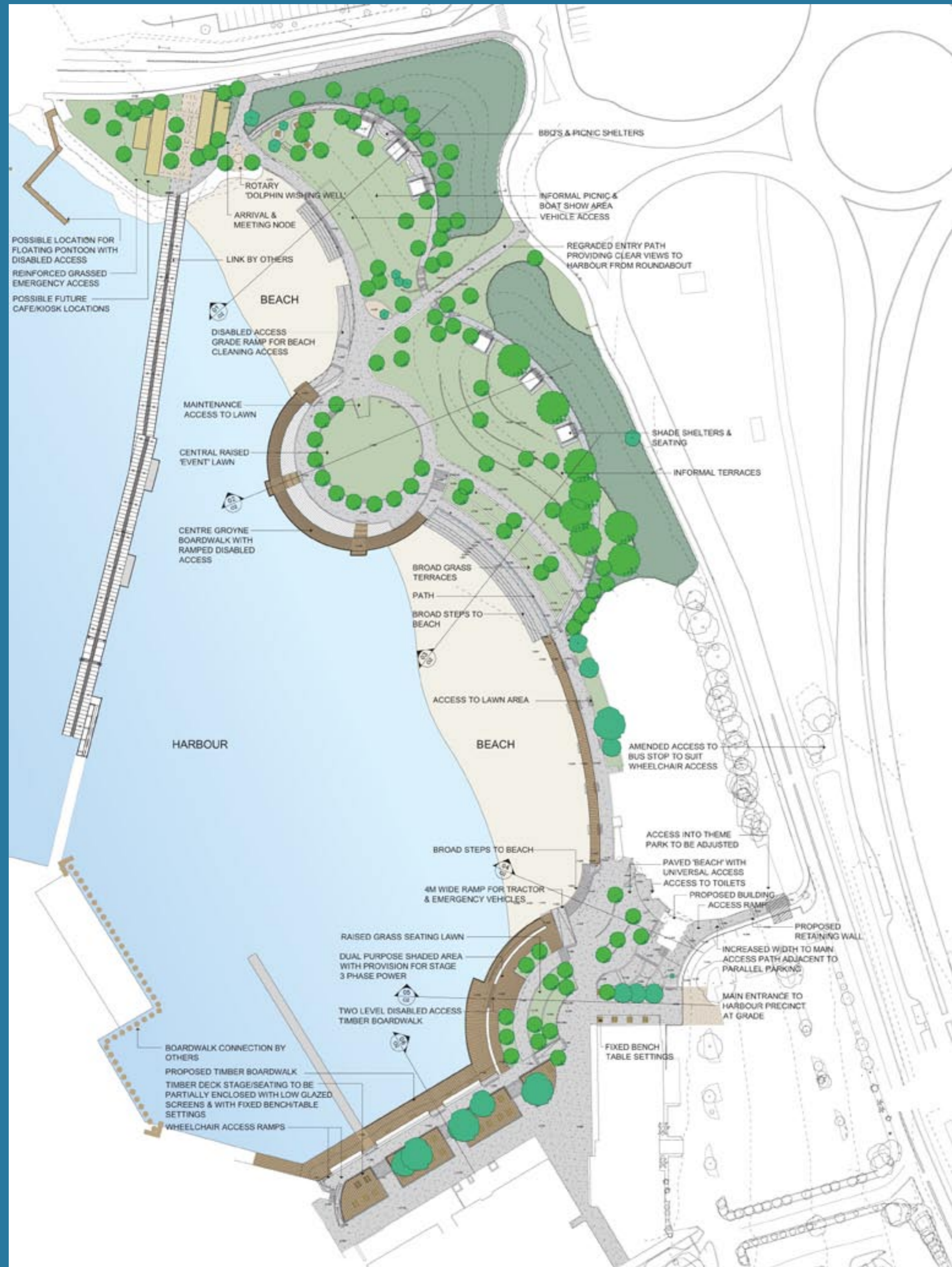

Hillarys Boat Harbour Precinct Upgrade



Hillarys Boat Harbour is to be made more family friendly with increased picnic areas, barbecue facilities and boardwalks as part of a proposed \$5 million upgrade plan.

A feature of the plan is the transformation of under utilised areas such as the paved centre groyne which has been redesigned and will incorporate a shaded and grassed picnic area linked to the water by a pedestrian boardwalk.

Boardwalks will also be used extensively throughout the plan to provide a pedestrian loop skirting the busier public areas of the harbour and bring the people visiting the facility closer to the water.

The Department for Planning and Infrastructure is now seeking comment on these latest plans for improvements before submitting a development plan to the Western Australian Planning Commission for approval.

If approved work will begin on the first improvements in August and continue over a number of years during the off peak trading periods for the harbour.

Other improvements included in the upgrade plan are:

- provision for a future community purpose building at entry to the eastern car park to provide a high profile location for police and security services, first aid and harbour information;
- the introduction of improved lighting throughout the precinct to increase safety and allow people to have greater confidence in using the facility;
- increased provision of BBQ and picnic facilities with more grassed areas, trees and shade structures;
- the construction of grassed terraces to the southern picnic area to improve safety and access to the boardwalk and beach;
- significant upgrades to public toilet facilities throughout the precinct and the construction of a new penholders ablution block close to KL jetties;
- better beach access; and,
- plans for a future kiosk area in the northern part of the improvement area.

For more information about the Hillary Boat Harbour Enhancement Program Precinct Upgrade Project Stages 2 and 3 people can visit the Department's website: www.dpi.wa.gov.au/imagine or contact the Harbour Manager on (08) 9448 7544.

